

5817CBXT

Wireless Commercial Transmitter

The 5817CBXT is a universal contact-monitoring transmitter that can be used with household and commercial fire and burglary-initiating devices such as door/window contacts, motion and glassbreak detectors, sprinkler water flow switches, tamper switches, post indicator valves, manual pull stations and remote duct detectors. Upon activation, it emits an RF signal to a control panel, sending a burglary or fire alarm to a central station.



FEATURES AND BENEFITS

- The 5817CBXT has three unique input loops (zones)
- The first loop (primary loop) is supervised and typically used for high-priority alarm reporting such as commercial fire or burglary (reporting transmission every four seconds)
- The second loop is the built-in, normally closed reed switch used in conjunction with magnet
- The third loop is another normally closed household burglary loop. All three loops may be used.
- A fourth (automatically enrolled) loop contains two tamper switches to protect the 5817CBXT
- UL Listed for residential and commercial fire and burglary

MOUNTING

1. Remove the transmitter cover by inserting the flat blade of a small screwdriver into the pry-off slot at the bottom end of the unit (on the right side closest to the cover's decorative ribs and twisting).
2. Disengage the supplied mounting plate from the unit by inserting the blade of a small screwdriver into the mounting plate release hole (see Figure 2) and pushing the locking tab out (see Figure 1). Slide the mounting plate downward along the case back.

Note: For this application, the alignment

guide strip along one edge of the mounting plate serves no function and may be broken away, if desired.

3. If concealed wiring is to be used, feed the wires through the concealed wiring entry hole on one corner of the plate (surface wiring is mentioned in step 5 below).
4. Install the mounting plate, with its caseholding posts pointing up, in the location selected as described in the installation instructions. Use the two flat-head screws supplied.

Note: To ensure proper operation of the unit's back tamper (when it is separated from the mounting plate), the screws must be anchored to a wall stud or other solid wood material.

5. Set the DIP switch (after the control panel has enrolled the transmitter's input ID's) for the desired primary loop characteristics, as described in the table on the following page.

5817CBXT Technical Specifications

Primary Loop Options Table	
Switch	DIP Switch Position
Setting	1
On	Repeating transmission (every 4 sec.) upon primary loop fault use high priority alarm, such as fire.
Off	Single transmission per primary loop change-of-state

Notes: a. In order for the control panel to enroll the transmitter, the DIP switch must be set to OFF (see Figure 3).

b. The auxiliary loops are not affected by the DIP switch settings.

Wiring Connections

Connect the loop wiring to the unit's terminals before installing the battery (see Figure 3).

Notes: a. Primary loop 1 is a supervised loop and must have an end-of-line (EOL) resistor (470K ohms, supplied) placed across the sensor. Additionally, for primary loop 1, a contact device may not be installed more than 20 feet from the transmitter.

b. If loop 2 is not going to be used, the magnet is not necessary.

c. If loop 3 is not going to be used, no connection is needed across its terminals. For UL household burglary and fire installations, the loop 3 contact device (if used) may not be more than 3 feet from the transmitter.

SPECIFICATIONS:

Dimensions:

1-9/16" W x 3-1/2" H x 1-3/16" D
(40mm x 89mm x 30mm)
Battery 3v Lithium

UL Listings:

Commercial Fire	UL 864
Household Fire	UL 985
Household Burg	UL 1023
Commercial Burg	UL 365, UL 609, UL 1076, UL 1610

Battery Type:

CR123 Lithium

Note: For UL commercial and household fire installations, only one initiating device may be connected to this transmitter. For UL commercial burglary installations, multiple initiating devices may be used as long as the devices all service the same function such as door/window contacts, motion or glassbreak detectors. All initiating devices must be located within the same room. No more than one wire per terminal may be connected. Use only 14-22AWG wire.

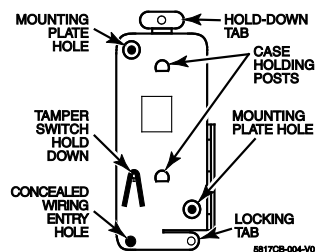

Figure 1. Mounting Plate

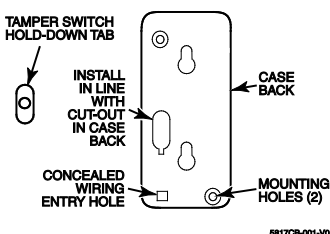

Figure 2. Case Back

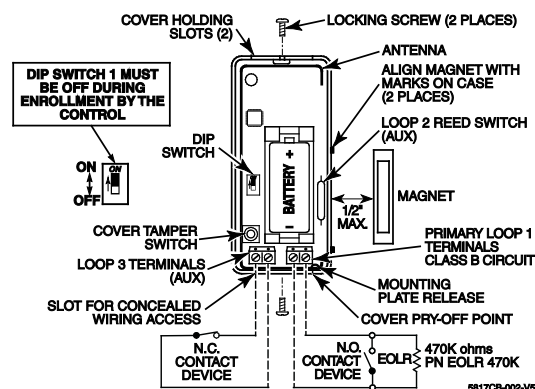

Figure 3. 5817CBXT Transmitter, Top Cover Removed

ORDERING

5817CBXT	Wireless Commercial Transmitter
-----------------	---------------------------------

For more information

resideo.com/pro



For more information
resideo.com

Resideo Technologies, Inc.

2 Corporate Center Drive,
Suite 100
P.O. Box 9040
Melville, NY 11747
1-800-645-7492

L/5817CBXTD/D | 04/21
© 2021 Resideo Technologies, Inc.
All rights reserved.